

SEE INSET BELOW

REVISIONS		
DATE	NAME OF P.L.S.	LICENSE # OF P.L.S.
9/24/02	J.R. WALKER	10294
11/4/03	J.R. WALKER	10294
9/3/04	J.R. WALKER	10294
10/23/06	B.A. GLEISSNER	34483
1/02/08	R.J. FARRAR	35836
6/23/10	R.T. HUGG	36737

MAURICE RIVER TOWNSHIP CUMBERLAND COUNTY

MAURICE RIVER TOWNSHIP CUMBERLAND COUNTY

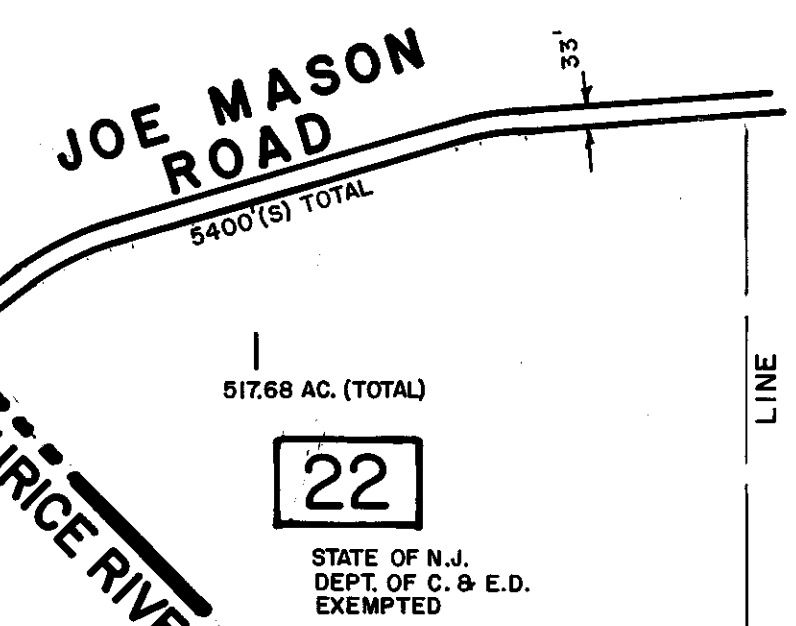

INSET
SCALE 1" = 400'

NEW JERSEY DEPARTMENT OF THE TREASURY
DIVISION OF TAXATION
LOCAL PROPERTY AND PUBLIC UTILITY BRANCH
APPROVED AS A TAX MAP PURSUANT TO THE
PROVISIONS OF CHAPTER 175, LAWS OF 1913, ETC.
FOR THE DIRECTOR, DIVISION OF TAXATION

J. H. [Signature]
P.E. & L.S.
Lic. #5009 SUPERINTENDENT
DATE DEC 8 1980 SERIAL NO. 593

CONTINUED ABOVE, LEFT

DATE	REVISION	BY
12-17-01	B22, L22, 27 Now N.J. Exempt, Rev'd A.C.	WPH
12-18-01	BL 22, L6, ADDED DIMENSIONS	WPH
2000	S.D.E.P. EXEMPT, REVISED A.C.	
8-10-98	B22, L3+5, N.J. Exempt, Rev'd Area	WPH
3-6-98	B-16, ADDED LOT 22 PER DEED	WPH
2-28-93	B/22 L26 REDUCE TO 1/4	CBA
2-28-92	B-16, L-38, 43 SUBD.	CBA
5-6-91	B-16, L-44 MINOR SUBD.	DECO
5-3-91	B-15, L-12 MINOR SUBD.	DECO
12-24-90	BLOCK 16, L 45, 46, 47 MIN. SUBD.	DECO
10-1-90	BLOCK 15, L 5, 24-27 CONSOLIDATION	DECO
10-1-90	BLOCK 15, L 4, 30-32 CONSOLIDATION	DECO

REVISED: 4-25-85
12-31-85
6-2-86
10-17-86

2-15-89 KTA

TAX MAP
TOWNSHIP OF DENNIS
CAPE MAY COUNTY, NEW JERSEY
SCALE: 1" = 400' APRIL 1, 1980
ALVIN C. HERMAN
NJ Lic. P.E. & L.S. NO. 13284
ALVIN C. HERMAN ASSOC. INC.
7 MECHANIC STREET
CAPE MAY COURT HOUSE, NJ 08210