

REVISIONS		
DATE	NAME OF P.L.S.	LICENSE # OF P.L.S.
9/24/02	J.R. WALKER	10294
9/3/04	J.R. WALKER	10294
10/23/06	B.A. GLEISSNER	34483

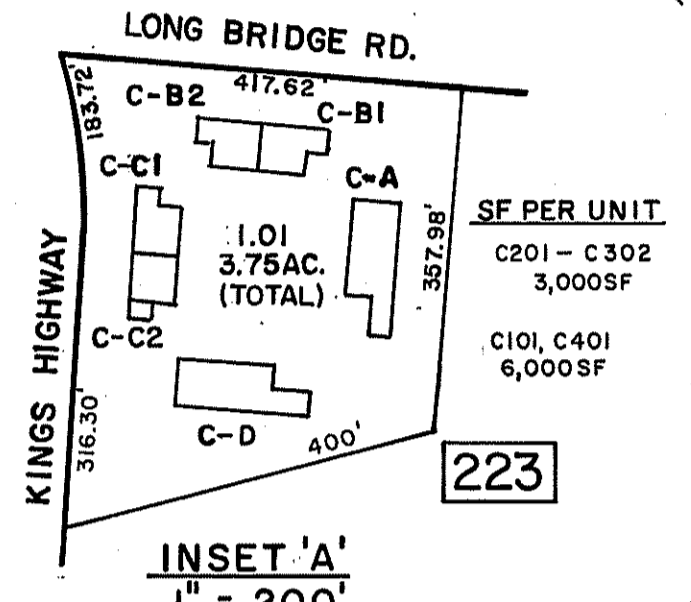
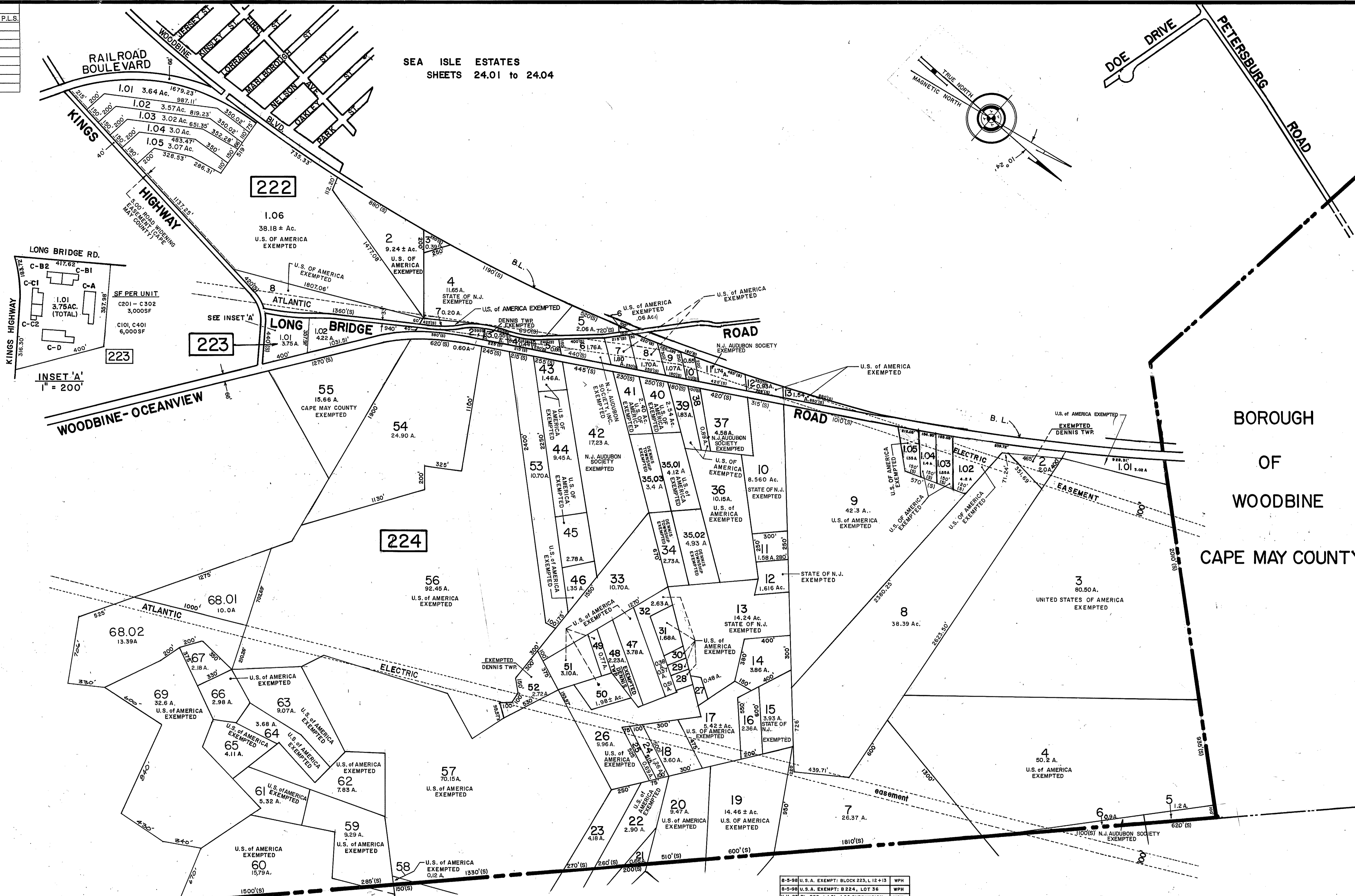

SEA ISLE ESTATES
SHEETS 24.01 to 24.04

BOROUGH
OF
WOODBINE
CAPE MAY COUNTY

UPPER TOWNSHIP
CAPE MAY COUNTY

DATE	REVISION	BY	DATE	REVISION	BY
8-5-98	U.S.A. EXEMPT; BLOCK 223, L 12-13	WPH			
8-5-98	U.S.A. EXEMPT; B 224, LOT 36	WPH			
11-1-97	BL 222, L 1.01 - 1.06 SUBDIVISION	WPH			
12-16-96	U.S.A. EXEMPT; B224, L 2, 22, 35.01, 48, B 222, L 6, B 223, L 7 & 8	WPH			
12-9-96	THE FOLLOWING ARE U.S.A. EXEMPTED: WPH B224, L 26, 28-32, 47A, 51, 56-66, 69	WPH			
4-2-96	B 224, L 34, 35.02, 35.03 TWP EXEMPTED	WPH			
12/30/94	B 222 L 7, B 224 L 19, 20, 34, 41	CBA			
12/7/93	B 224 LOT 72.01 REMOVED	CBA			
12/2/93	B 224 LOT 2, 26	CBA			
12/2/93	B 224 LOT 7, 35, 37 EASEMENT	CBA			
12/8/92	B 224, L 1/101, U.S.A. EXEMPTED	CBA			
2/20/92	B 222, L 7 / U.S.A. EXEMPTED	CBA			
2-5-92	B 224, L 35 MIN. SUBD.	CBA			
7-11-90	B 224, L 4, 9, 20 U.S.A. EXEMPTED	DECO			

NEW JERSEY DEPARTMENT OF THE TREASURY
DIVISION OF TAXATION
LOCAL PROPERTY AND PUBLIC UTILITY BRANCH

APPROVED AS A TAX MAP PURSUANT TO THE PROVISIONS OF CHAPTER 175, LAWS OF 1913, ETC. FOR THE DIRECTOR, DIVISION OF TAXATION

J. H. Deiana
P.E. & L.S.
SUPERINTENDENT

DATE: DEC 8 1990 SERIAL NO. 598

TAX MAP
TOWNSHIP OF DENNIS
CAPE MAY COUNTY, NEW JERSEY
SCALE: 1" = 400' APRIL 1, 1980
ALVIN C. HERMAN
NJ LIC. P.E. & L.S. NO. 13284
ALVIN C. HERMAN ASSOC. INC.
7 MECHANIC STREET
CAPE MAY COURT HOUSE, NJ 08210

CONTINUED ABOVE LEFT

DATE	REVISION	BY	DATE	REVISION	BY
10-18-99	ADDED U.S.A. EXEMPTED: BL 222, L 2, BL 224, LOTS 17, 19, 38 THRU 41, 43, 44, 45, 50. REVISED ACRES, BL 222, L 2, BL 224, LOTS 17, 19, 38	WPH			

2-17-89 K.T.A.
1-5-84
10-27-81
REVISED 10-1-81